

**Presqu'ile Winery**  
 2540 Clark Avenue  
 Santa Maria, CA 93455  
 APN 129-150-145, 067, 068

**MÜLLER**  
 Food & Laundry Facilities Planning & Design  
 1564 Deerpark Drive, Madison, NJ 08052  
 TEL: 775-782-1110 FAX: 775-782-1267  
 E-Mail: frank@mulderdesign.com

Foodservice Equipment  
 Plan

scale: 1/4"=1'-0"

revision:            date:

Coordination Review 07.17.2009

75% Coordination Review 08.28.2009

job no: 0801

drawn:

checked:

issue:

28 AUGUST 2009

sheet no:

**FS-3.0**  
 of #  
 sheets

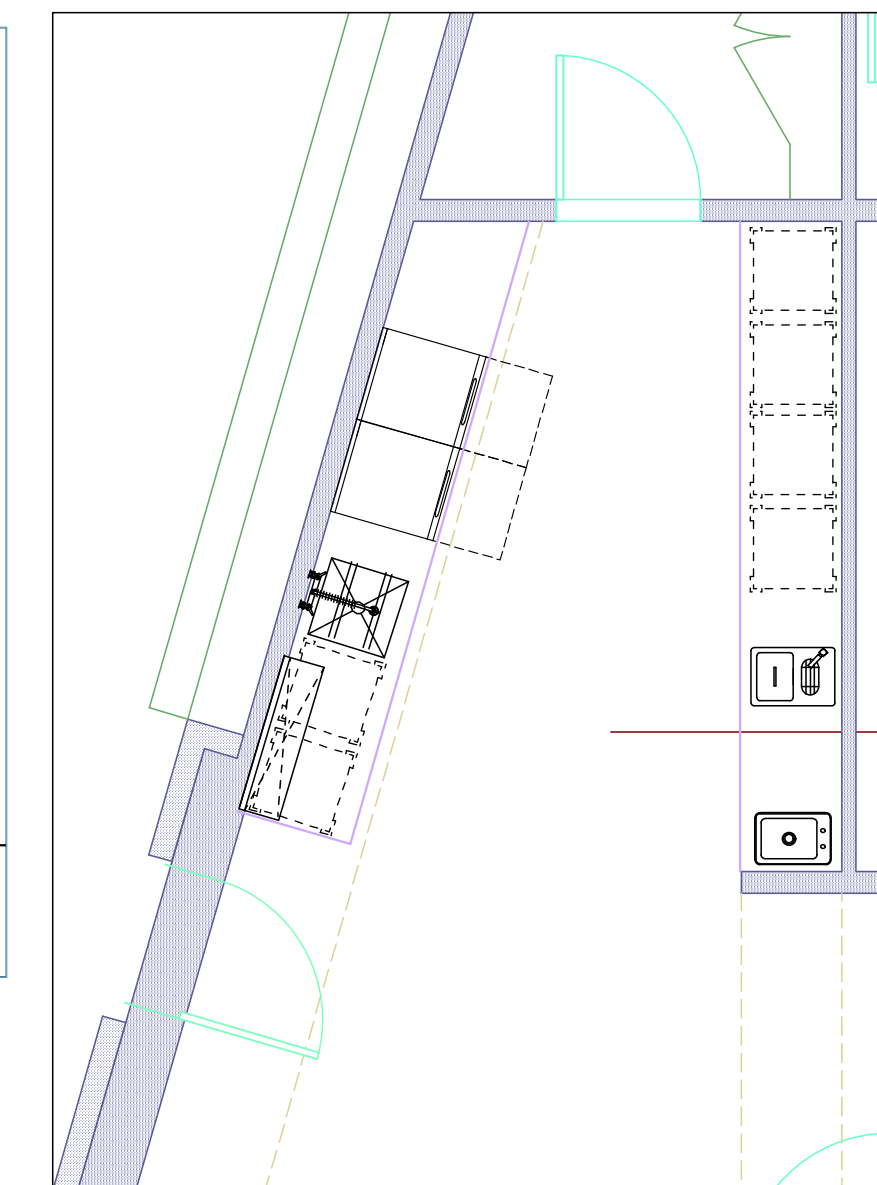
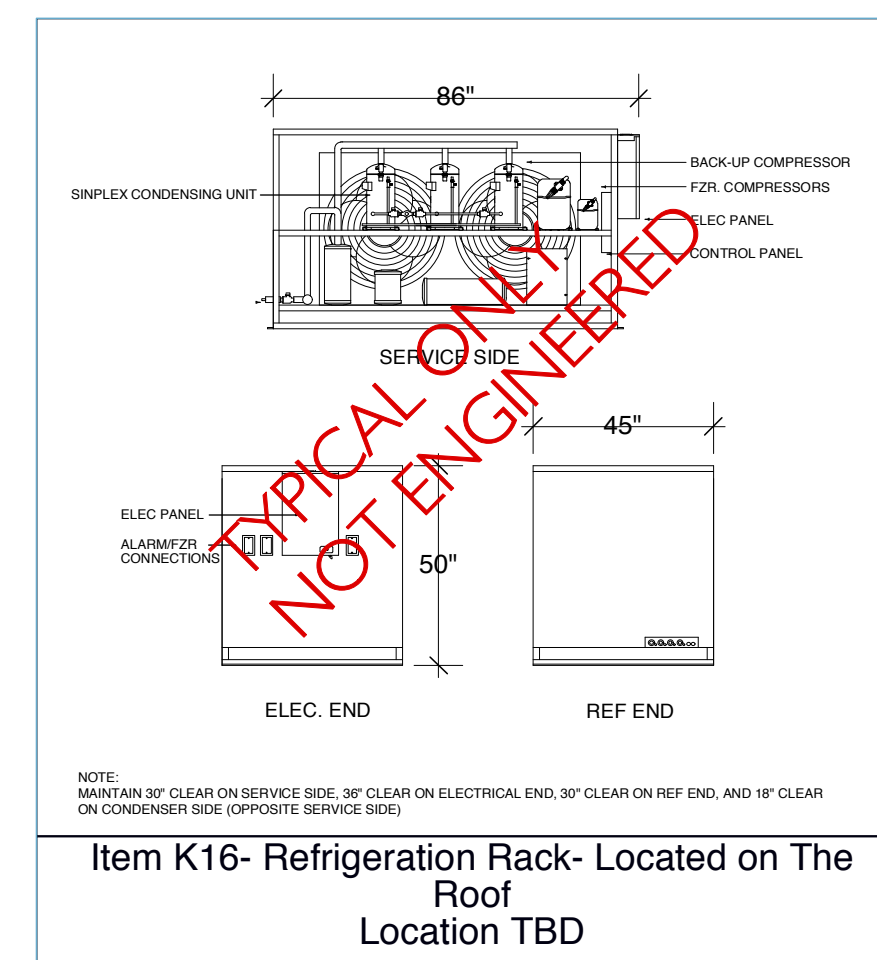
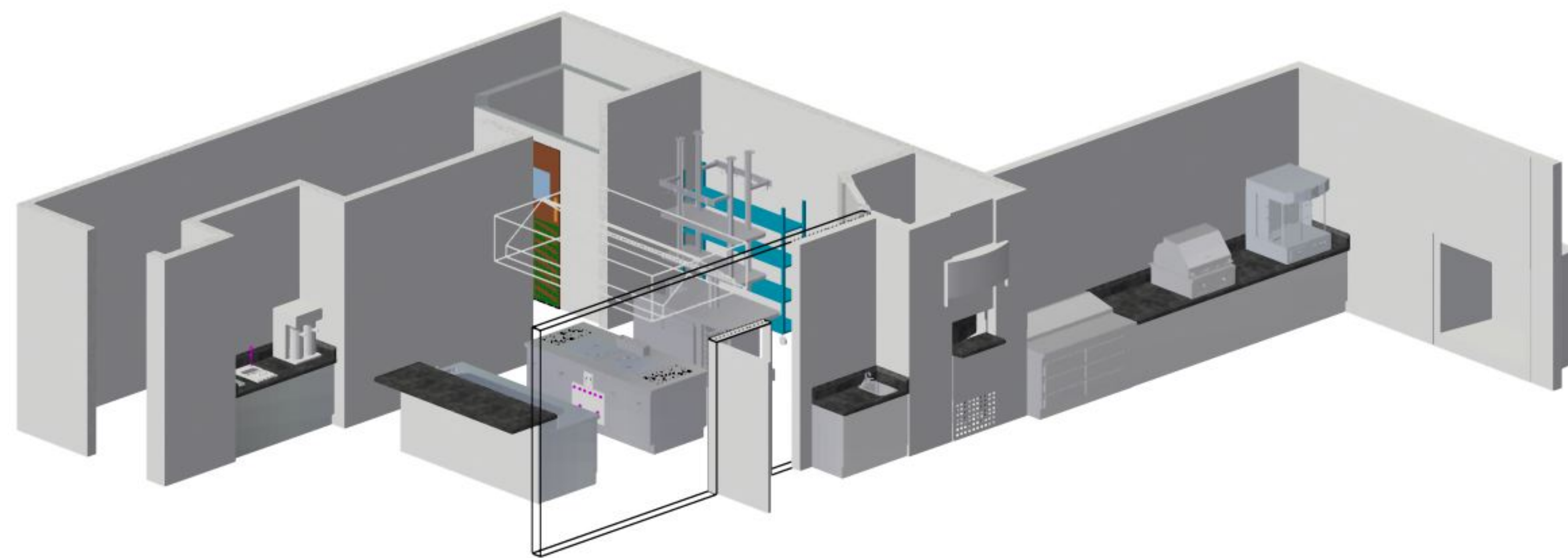

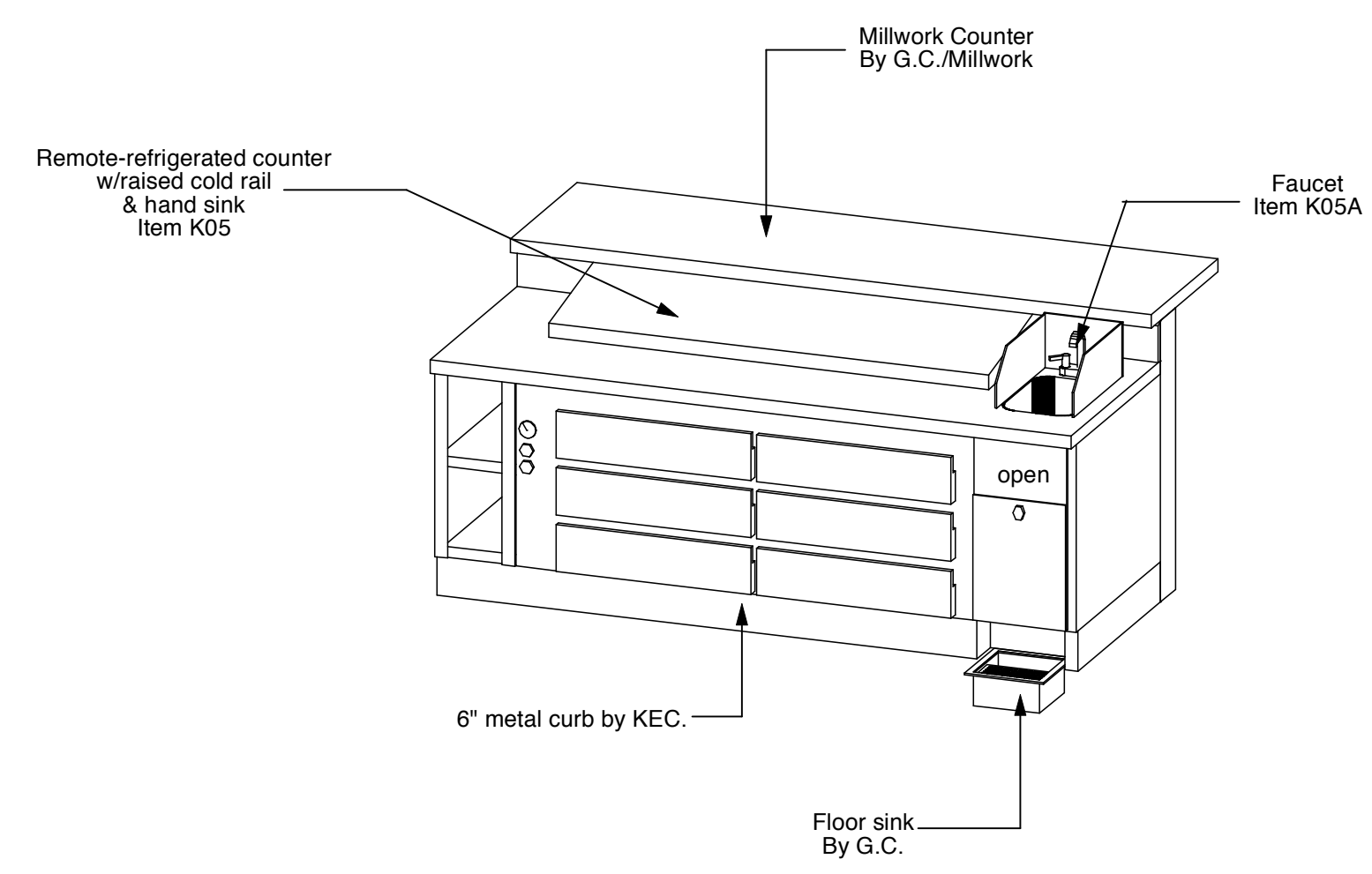

**E1** Chef's pantry counter-K Area  
FS6.0 Right isometric view 1/2"=1'0"

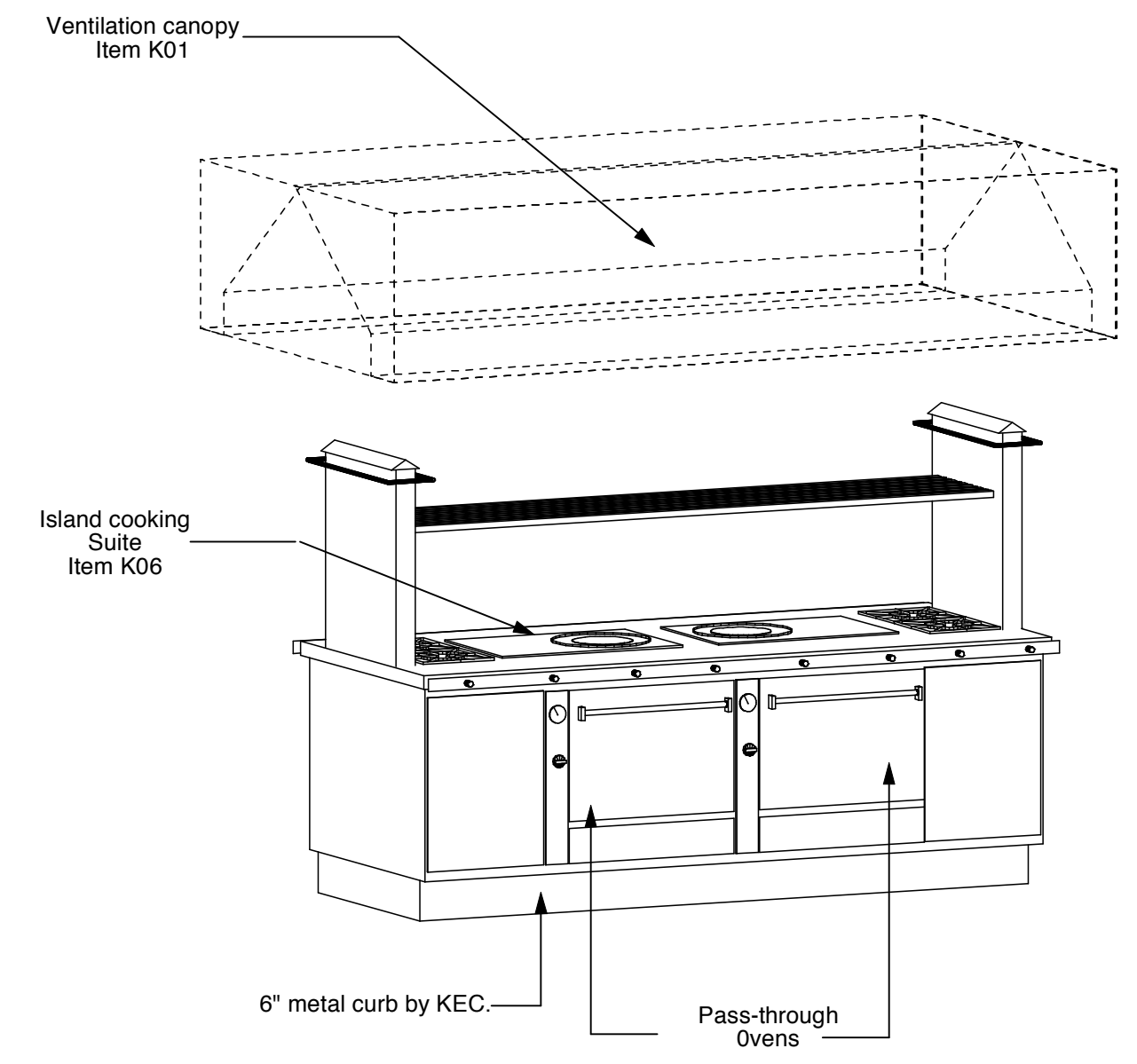

**E2** Island cooking suite-K Area  
FS6.0 Left isometric view 1/2"=1'0"

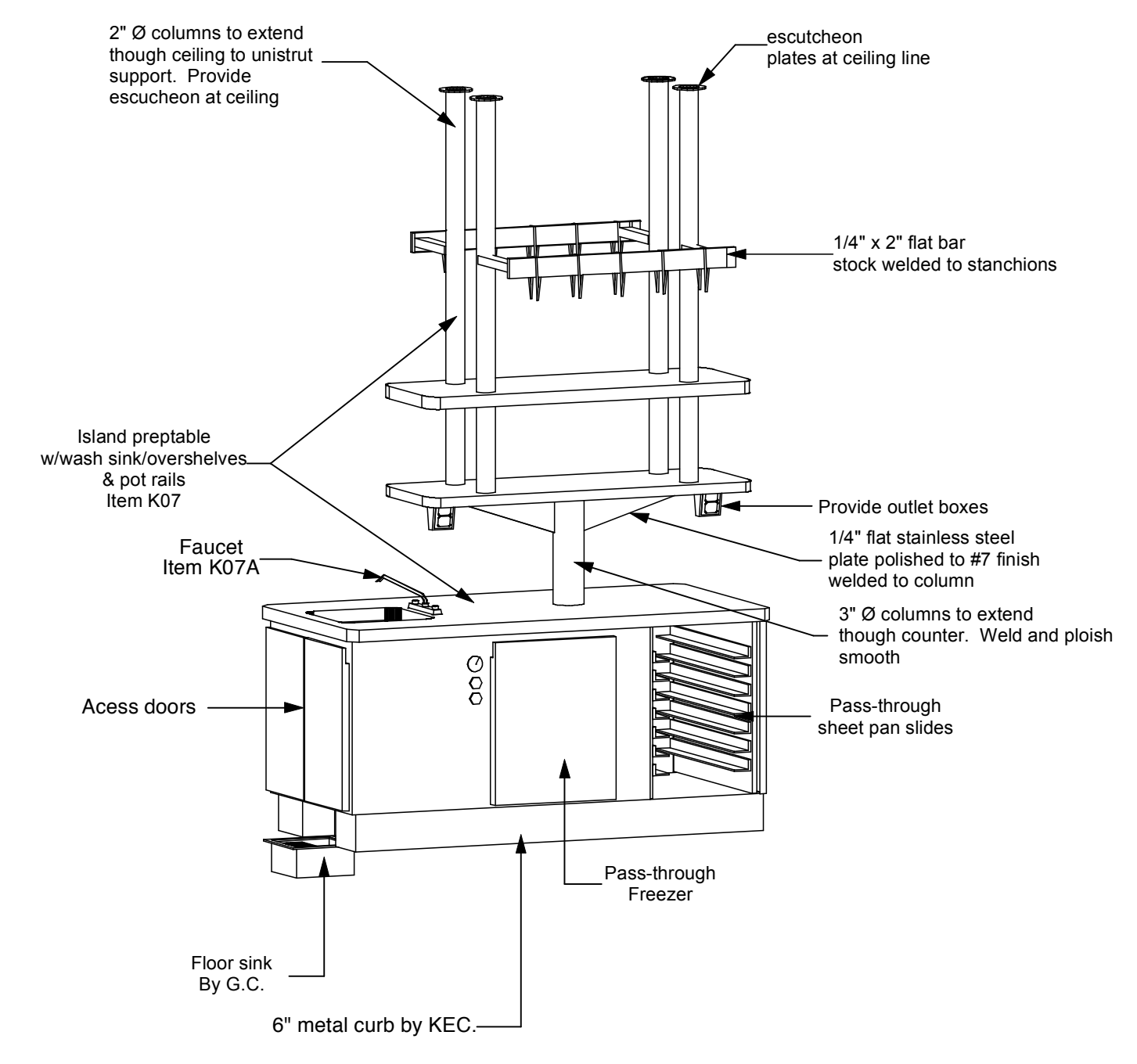

**E3** Island Prep counter-K Area  
FS6.0 Left isometric view 1/2"=1'0"

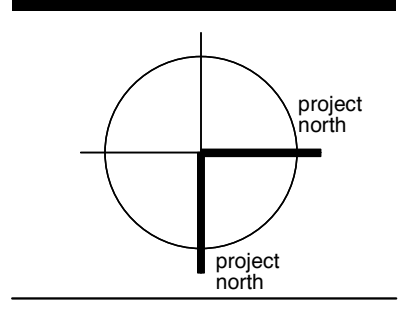

**Presqu'ile Winery**  
2540 Clark Avenue  
Santa Maria, CA 93455  
APN 129-150-145, 067, 068

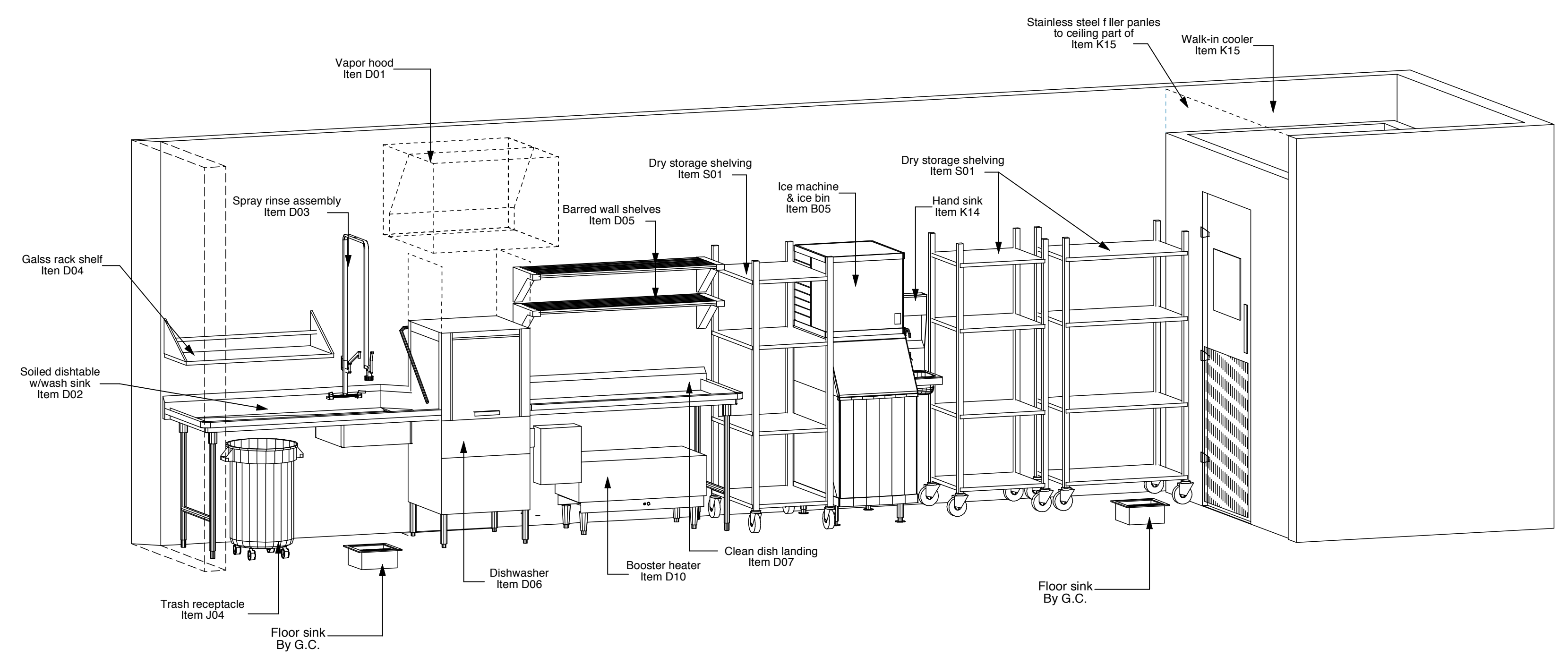

**E4** Dishwashing, Ice, Walk-in cooler & Dry Storage-D Area  
FS6.0 Left isometric view 1/2"=1'0"

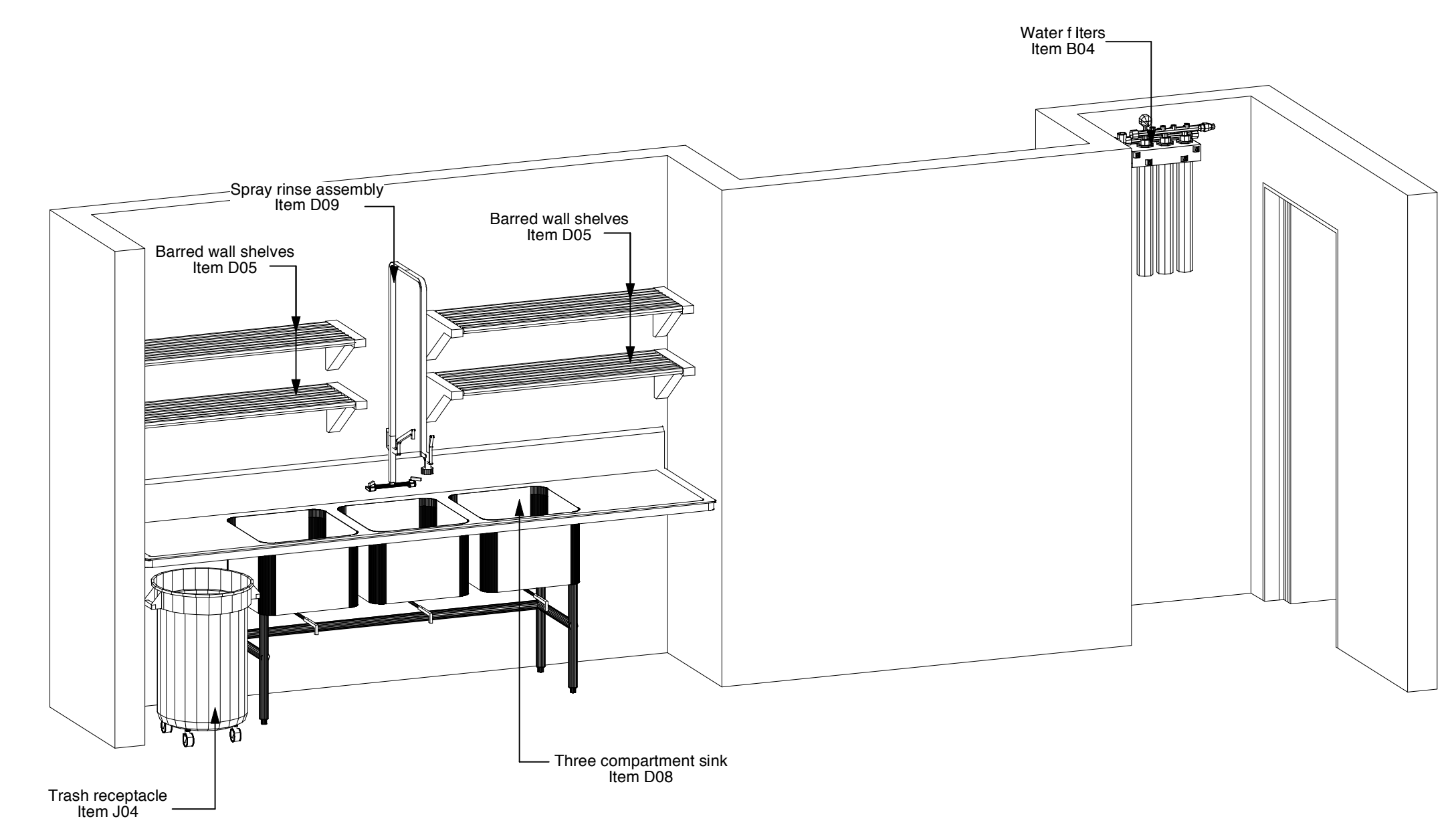

**E5** Three Compartment sink-D Area  
FS6.0 Left isometric view 1/2"=1'0"

**MÜLLER**  
Food & Laundry Facilities Planning & Design  
1564 Depot Drive, Madison, NJ 08422  
TEL: 775/782-1110 FAX: 775/782-1267  
E-Mail: [trans@mullerdesign.com](mailto:trans@mullerdesign.com)

Foodservice Equipment  
Elevations

scale:

revision:      date:

Coordination Review 07.17.2009

75% Coordination Review 08.28.2009

job no: 0801

drawn:

checked:

issue:

28 AUGUST 2009

sheet no:

**FS-6.0**

of #  
sheets